

# assembly instructions

Flick&Click\_C90  
demo module

 melaco

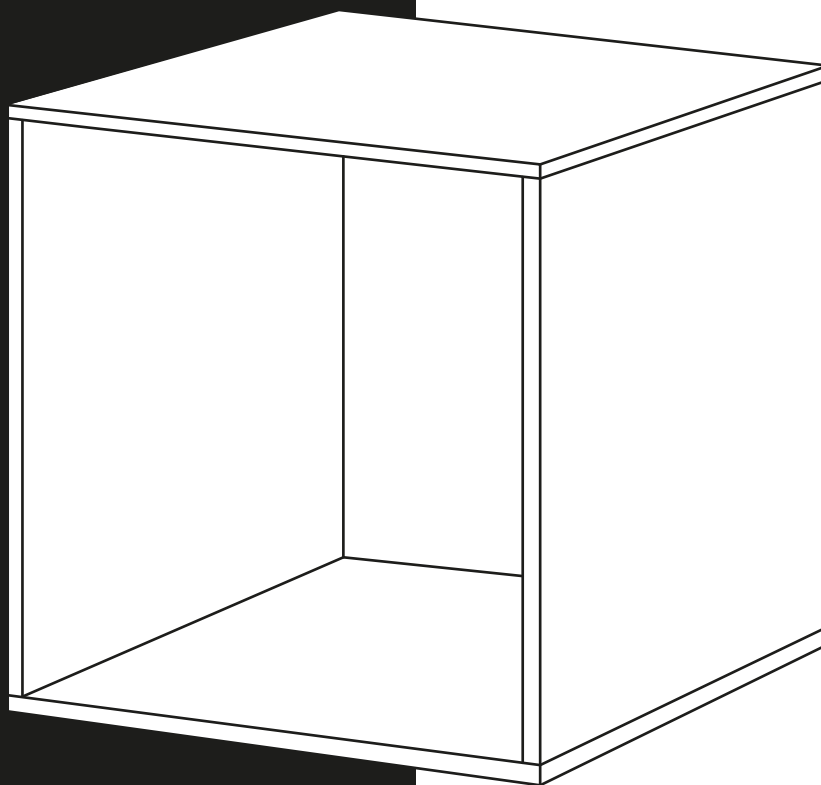

**WATCH THE  
MOUNTING VIDEO**

[youtu.be/5qfgCxUCP0k](https://youtu.be/5qfgCxUCP0k)

MELACO sp. z o.o.  
Ciepielowska 9,  
67-100 Nowa Sól, Poland

office: +48 68 38 792 08  
sales: +48 68 38 723 94

more info:

[www.melaco.com.pl](http://www.melaco.com.pl)

[www.flickandclick.eu](http://www.flickandclick.eu)

[melaco@melaco.com.pl](mailto:melaco@melaco.com.pl)

fig. 1

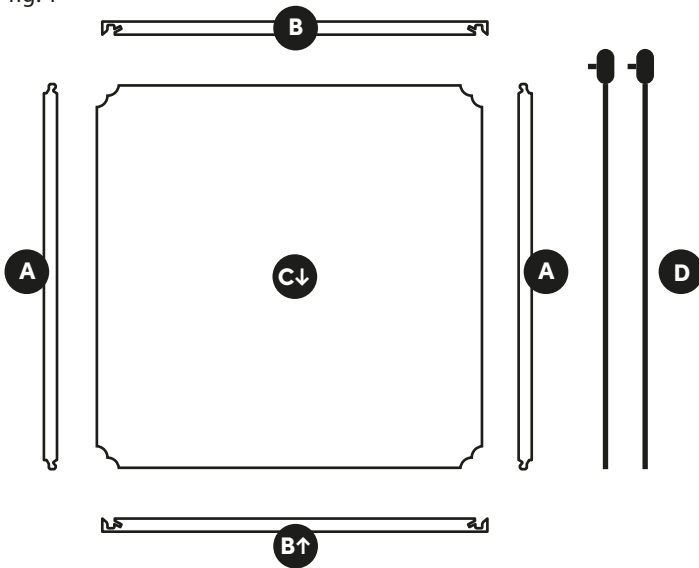

## included

### MODULE ELEMENTS

- A** ▶ Side walls (2 pcs.)
- B** ▶ Top and bottom panel, one marked with an arrow
- C** ▶ Back wall marked with an arrow
- D** ▶ Dismantling pins (2 pcs.)



**ASSEMBLY OF ELEMENTS  
DOES NOT REQUIRE  
THE USE OF TOOLS**

## instruction

### HOW TO ASSEMBLE A MODULE

fig. 2

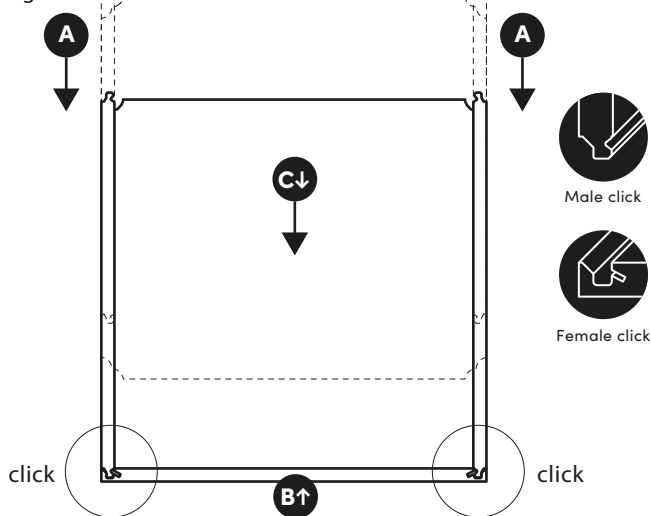

fig. 3

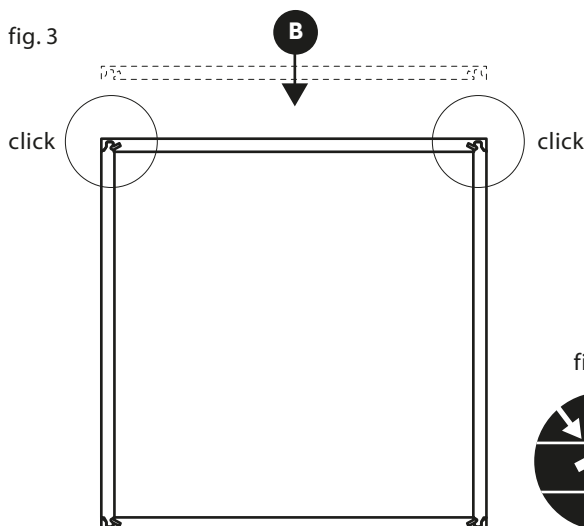

fig. 4



- 1 Unpack the elements and sort them by dimensions (fig. 1).
- 2 Take the panel marked with an arrow (B↑).
- 3 Place the panel (B↑) on an even, horizontal surface, with anti-scratch material first..
- 4 The element has a cut for the rear wall. Arrange it so that it is closer to you.
- 5 Take the next side (A) of the cabinet, check where the cut is.
- 6 Make sure that the cut is on the same side as in the first element! Press the element gently to match the male click to the female click or vice versa (depending on the element in your hand).
- 7 You will hear a click when you fold it properly. This means that the elements have been connected.
- 8 If necessary, align the parts so that the leading edges meet evenly.
- 9 Take the other side (A) and repeat the operation for the other side. You have received a U-shaped piece with a cut on one side (fig. 2).
- 10 Take the back wall (C↓) and slide it into the cut so that the element surface is flush with the cabinet edges and the arrow is pointing towards the arrow on the panel(B↑) (fig. 3).
- 11 Time for the second panel (B) of the module. Connect it simultaneously with the male clicks on both sides of the module (A), making sure that the rear wall fits into the rebate (fig. 3).
- 12 The module is ready!
- 13 The module can be disassembled using specially designed pins (D).
- 14 The module is disassembled in the reverse order, first placing both pins (D) in the triangular indentation of the rim (B), on the right and left sides (fig. 4).